

**DATE:** April 28, 2025

**TO:** 911 Emergency Response Advisory Committee

**FROM:** Jenn Felter, Communications Manager, Washoe County Sheriff's Office 775/333-7017, [jfelter@washoecounty.gov](mailto:jfelter@washoecounty.gov)  
Cody Shadle, Director, Public Safety Dispatch, City of Reno 775/334-2212  
[shadlec@reno.gov](mailto:shadlec@reno.gov)

**SUBJECT:** REQUEST FOR REIMBURSEMENT TO WASHOE COUNTY SHERIFF'S OFFICE COMMUNICATIONS and CITY OF RENO PUBLIC SAFETY DISPATCH CENTER FOR WATSON CONSOLE EQUIPMENT TO SERVE PUBLIC SAFETY ANSWERING POINTS (PSAPs) [For possible action] - A review, discussion and possible action to approve, deny or otherwise modify a request to fund the purchase of thirty-four (34) Watson dispatch console workstations used to house critical 911 call handling and dispatching equipment in the co-located Communications Dispatch Center at 5195 Spectrum Boulevard in an amount NOT TO EXCEED \$796,584.50.

**SUMMARY**

REQUEST FOR REIMBURSEMENT TO WASHOE COUNTY SHERIFF'S OFFICE COMMUNICATIONS and CITY OF RENO PUBLIC SAFETY DISPATCH CENTER FOR WATSON CONSOLE EQUIPMENT TO SERVE PUBLIC SAFETY ANSWERING POINTS (PSAPs) [For possible action] - A review, discussion and possible action to approve, deny or otherwise modify a request to fund the purchase of thirty-four (34) Watson dispatch console workstations used to house critical 911 call handling and dispatching equipment in the co-located Communications Dispatch Center at 5195 Spectrum Boulevard in an amount NOT TO EXCEED \$796,584.50.

The attached quote reflects total costs for materials, installation and a 10% contingency for a total amount not to exceed \$796,584.50.

**NRS APPLICABLE:** *NRS 244A.7645*

Provides approval of costs associated with purchasing, leasing or renting equipment and software necessary to operate the enhanced telephone system, including, without limitation, equipment and software that identify the number or location from which a call is made, upgrade and replacement of equipment necessary for the operation of the enhanced telephone system.

## **STAKEHOLDER REVIEW(s)**

Stakeholders are the area primary Public Safety Answering Points (PSAP) – Washoe County Sheriff's Office Communications, City of Sparks Emergency Communications and City of Reno Public Safety Dispatch, and each PSAP's contracted Agencies.

## **PREVIOUS ACTION BACKGROUND**

On May 20<sup>th</sup>, 2021, the E-911 Emergency Response Advisory Committee approved the purchase of Watson Dispatch console workstations for Sparks Police Departments, Communications Center.

## **FISCAL IMPACT**

The Enhanced 911 Fund is a special revenue fund which receives revenue pursuant to NRS 244A.7643 in the form of telephone surcharges collected to support the emergency reporting system.

## **RECOMMENDATION**

It is recommended that the E911 Emergency Response Advisory Committee approve the request co-presented by Washoe County Sheriff's Office Communications and the City of Reno Public Safety Dispatch co-located Centers at 5195 Spectrum Blvd. for the Watson dispatch workstation consoles in an amount NOT TO EXCEED: **\$796,584.50.**

## **POSSIBLE MOTION**

Move to approve that the E911 Emergency Response Advisory Committee approves the request co-presented by Washoe County Sheriff's Office Communications and the City of Reno Public Safety Dispatch co-located Centers at 5195 Spectrum Blvd. for the Watson dispatch workstation consoles in an amount NOT TO EXCEED: **\$796,584.50.**

## Reno-Washoe County 911

<b>Specified For:</b>	Reno/Washoe County 911	<b>Watson Rep Firm:</b>	Watson Consoles West
<b>Contact Name:</b>	Cody Shadle	<b>Watson Sales Rep:</b>	Quint Andrae
<b>Phone Number:</b>	7753342212	<b>Phone Number:</b>	3603941300
<b>Email Address:</b>	shadlec@reno.gov		

**Project Summary:** 30 Mercury Pro Consoles and 4 Mercury Corner Consoles

Contract: HGAC EC07-23

### Call Takers Include:

78"W Pro Worksurface – Height-Adjustable with Depth Adjustment, Environmental Control and In-Dash Power  
- Environmental Control: Forced Air Heat, Cooling Fans, LED Ambient Lighting and Dimmable LED Task Lighting  
- In-Dash Power: 2 Power Outlets  
Single Tier Monitor Array – Height-Adjustable with Individually Adjustable Monitor Arms  
Technology Bridge Storage to Accommodate up to (3) Mid-Tower PCs (Max Dimensions per Unit: 7"W x 15"H x 15.75"D)  
Personal Storage – Door / Box  
Screens – 54"H Fabric and Clear Acrylic with Uplighting (42"H Fabric + 12"H Acrylic)  
Accessories – Status Light – Red / Yellow / Green with 12"H Pole and Manual Switch Kit, Single Cup Holder, Pendant Drawer

### Dispatchers Include:

90"W Pro Worksurface – Height-Adjustable with Depth Adjustment, Environmental Control and In-Dash Power  
- Environmental Control: Forced Air Heat, Cooling Fans, LED Ambient Lighting and Dimmable LED Task Lighting  
- In-Dash Power: 2 Power Outlets  
Single Tier Monitor Array – Height-Adjustable with Individually Adjustable Monitor Arms  
Technology Bridge Storage to Accommodate up to (3) Mid-Tower PCs (Max Dimensions per Unit: 7"W x 15"H x 15.75"D)  
Personal Storage – Door / Box  
Screens – 54"H Fabric and Clear Acrylic with Uplighting (42"H Fabric + 12"H Acrylic)  
Accessories – Status Light – Red / Yellow / Green with 12"H Pole and Manual Switch Kit, Single Cup Holder, Pendant Drawer

### Supervisors Include:

42"W Corner Worksurface – Height-Adjustable with Environmental Control and In-Dash Power  
- Environmental Control: Forced Air Heat, Cooling Fans, LED Ambient Lighting and Dimmable LED Task Lighting  
- In-Dash Power: 2 Power Outlets  
Single Tier Monitor Array – Height-Adjustable with Individually Adjustable Monitor Arms  
Technology Bridge Storage to Accommodate up to (4) Mid-Tower PCs (Max Dimensions per Unit: 7"W x 15"H x 15.75"D)  
Team Desk – 39"D x 30"W Worksurface with Box / Box / File Storage (Between Supervisor 2 and 4)  
Screens – 54"H Fabric and Clear Acrylic with Uplighting (42"H Fabric + 12"H Acrylic) (Note: No Return Screens Between Supervisor 1 and 2, or Supervisor 3 and 4)  
Accessories – Status Light – Red / Yellow / Green with 12"H Pole and Manual Switch Kit, Single Cup Holder, Pendant Drawer

<b>Quote Date:</b>	3/31/2025	<b>Quote Expiration</b>	6/30/2025	<b>Quote Revision:</b>	06	<b>Watson Account Manager:</b>	Kelsey Hoskins
--------------------	-----------	-------------------------	-----------	------------------------	----	--------------------------------	----------------

## Reno-Washoe County 911

**Specified For:** Reno/Washoe County 911  
**Contact Name:** Cody Shadle  
**Phone Number:** 7753342212  
**Email Address:** shadlec@reno.gov

**Watson Rep Firm:** Watson Consoles West  
**Watson Sales Rep:** Quint Andrae  
**Phone Number:** 3603941300

### Project Summary Continued:

### Tech Port Selection:

Technology Ports Per Position - (4) USB-A Data I (4) USB-C Data I (2) Dual USB-A+C Charging I (1) RJ45/CAT6 I (1) RJ11/Phone I (1) 35mm Audio \*REQUIRES SELECTION PRIOR TO ORDER\*

**Finish Selection:** Unselected (Rendered In: Arches with Tensile Fabric \*REQUIRES SELECTION PRIOR TO ORDER\*

### Installation:

Type of Site – Empty Room  
Pre-Installation Site Prep – None  
Location – 2nd Floor with Elevator (Needs Confirmation on Elevator Size)  
Electrical Source – Raised Floor, 20 AMPS  
Prevailing Wage or Union – Prevailing Wage = Yes, Union Labor = No  
Additional Information – Quoted as prevailing wage per local wage schedule. This does not include any union requirements.

**Quote Date:** 3/31/2025    **Quote Expiration** 6/30/2025    **Quote Revision:** 06    **Watson Account Manager:** Kelsey Hoskins



## Terms and Conditions

### Drawings and Floorplans

It is necessary that accurate room dimensions and features are provided to Watson for space planning and installation. Watson commits to providing product symbols that are correct in size. It is the responsibility of the customer to verify that the room dimensions and features provided to Watson are accurate prior to submitting a purchase order.

All purchase orders must be accompanied by the drawing and quote that has been approved for manufacture. Watson quotes are valid 90 days from the date of issue.

### Purchase Orders and Order Acknowledgments

Purchase orders should be submitted via email to:

**orders@watsonfg.com**

All purchase orders must include the following information:

- Sold-to information including billing address and contact name with email and phone number
- Ship-to information including installation address and contact name with email and phone number
- Purchase order number
- Order total
- Final finish selections
- Approved final drawing and quote for manufacture (proposal and revision number must match across all pages)
- Requested delivery / installation date

Any omission may result in the delay of processing the order. All quotations, acknowledgments, and invoices are subject to corrections for errors or omissions.

All orders and subsequent change orders must be in writing. Watson will issue a written acknowledgment that includes estimated ship and arrival dates. All orders must ship within one year of submittal. Customers should verify the acknowledgment for accuracy. The acknowledgment is the final agreement between Watson and the customer.

### Order Cancellations and Changes

Acknowledged orders may not be changed or canceled, in whole or in part, without prior written consent of Watson.

Orders for which production has started may not be canceled. Orders that include non-standard products and non-standard finishes may not be canceled. In the event of cancellations prior to the start of production, for standard products, the customer will be liable for cancellation charges of 25% of the order total.

Any approved order change will require the customer to resubmit the approved final drawing and quote reflecting the requested change. An order change may affect the delivery date. Expenses incurred because of order changes will be charged to the customer.

### Taxes

All sales, use, excise, and other applicable taxes are the purchaser's responsibility and will be invoiced to the purchaser. If purchaser claims an exemption from such taxes, it shall be the purchaser's responsibility to furnish an appropriate exemption certificate at the time the order is placed.

### Payment Terms

Orders are invoiced at time of shipment. When credit is extended, standard terms are Net 30 unless otherwise stipulated in contractual agreements.

Past due accounts will be charged the lesser of 1-1/2% per month or the highest rate permitted by law plus all collection costs, including reasonable attorney's fees and expenses.

Credit card payments are accepted up to \$5,000. Payments above that amount can be made by check or ACH.

### Freight

Freight will be quoted on a per project basis considering destination location, order size and weight as well as the current freight market. Watson Console freight terms are FOB destination to all 50 US States.

Charges incurred by Watson complying with non-standard shipment requests such as inside delivery, expediting, redelivery, weekend delivery, unpacking, straight trucks, specific driver requests or temporary holding will be invoiced to the purchaser.

### Freight Claim

We'll file the freight claim on your behalf.  
But to do that – we'll need your help.

**FREIGHT DAMAGE:** It is the customers responsibility to examine products upon receipt, note the damage or shortage on the bill of lading, and to notify Watson within 24 hours of delivery. Failure to provide notice within 24 hours constitutes acceptance of the product.

**CONCEALED DAMAGE:** Claims must be made by the customer in writing and with photographs within five (5) business days after delivery. Failure by the customer to make any concealed damage claim within five (5) business days constitutes acceptance of the product and a waiver of any apparent damages.

### Storage

We understand that projects sometimes face unforeseen delays. If the request to move an order out is received more than 25 business days prior to the acknowledged ship date, we can likely accommodate that request without additional cost. If the request to move an order out is received less than 25 business days prior to the acknowledged ship date, customers may opt to contract storage with Watson for up to 30 days post-ship date. Watson charges a storage fee of \$1 per day per \$1,000 of the total order invoice. The minimum storage fee is \$250. When storage occurs, we will consider that the product has been delivered to the customer for all purposes, and invoicing will occur. Costs for storage will be subsequently invoiced to the customer. Please note that we can accept only one request to move out the order ship date. Any additional requests for a delay in shipping will be managed via our storage policy terms.

### Force Majeure

Watson shall not be liable for any loss, damage, or delay resulting from forces beyond its reasonable control including fire, flood, strike or other labor difficulty, act of God, or due to any cause beyond its reasonable control. In the event of any such delay, delivery will be postponed by such length of time as may be reasonably necessary to accommodate for the delay.

Revision Date 12-16-2024

Project

Reno-Washoe County 911

Proposal 1

Quote Revision: 06

Quote Date: 3/31/2025

Drawn By: KH

Watson Sales Rep

Quint Andrae

Watson Account Manager

Kelsey Hoskins

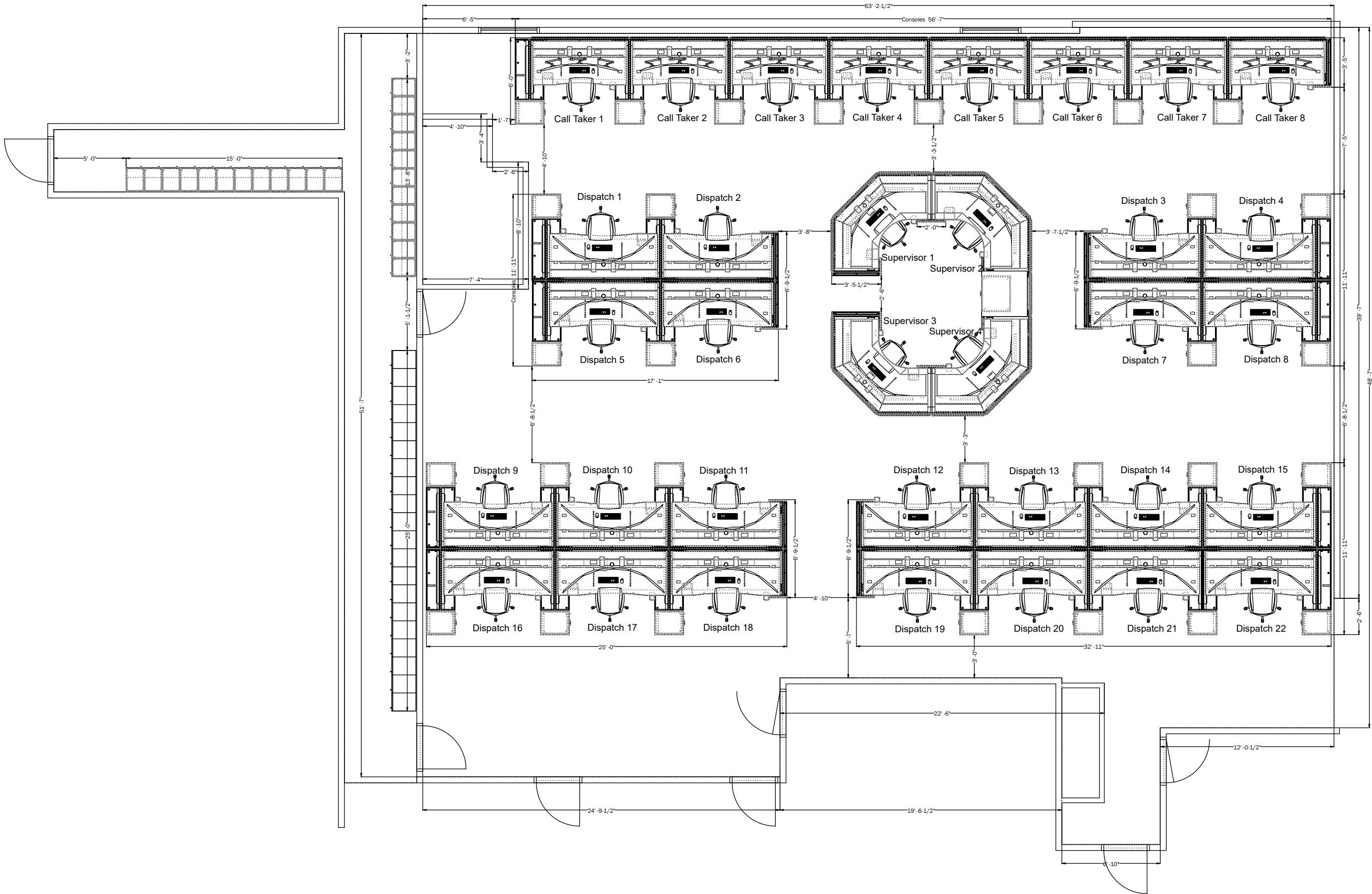



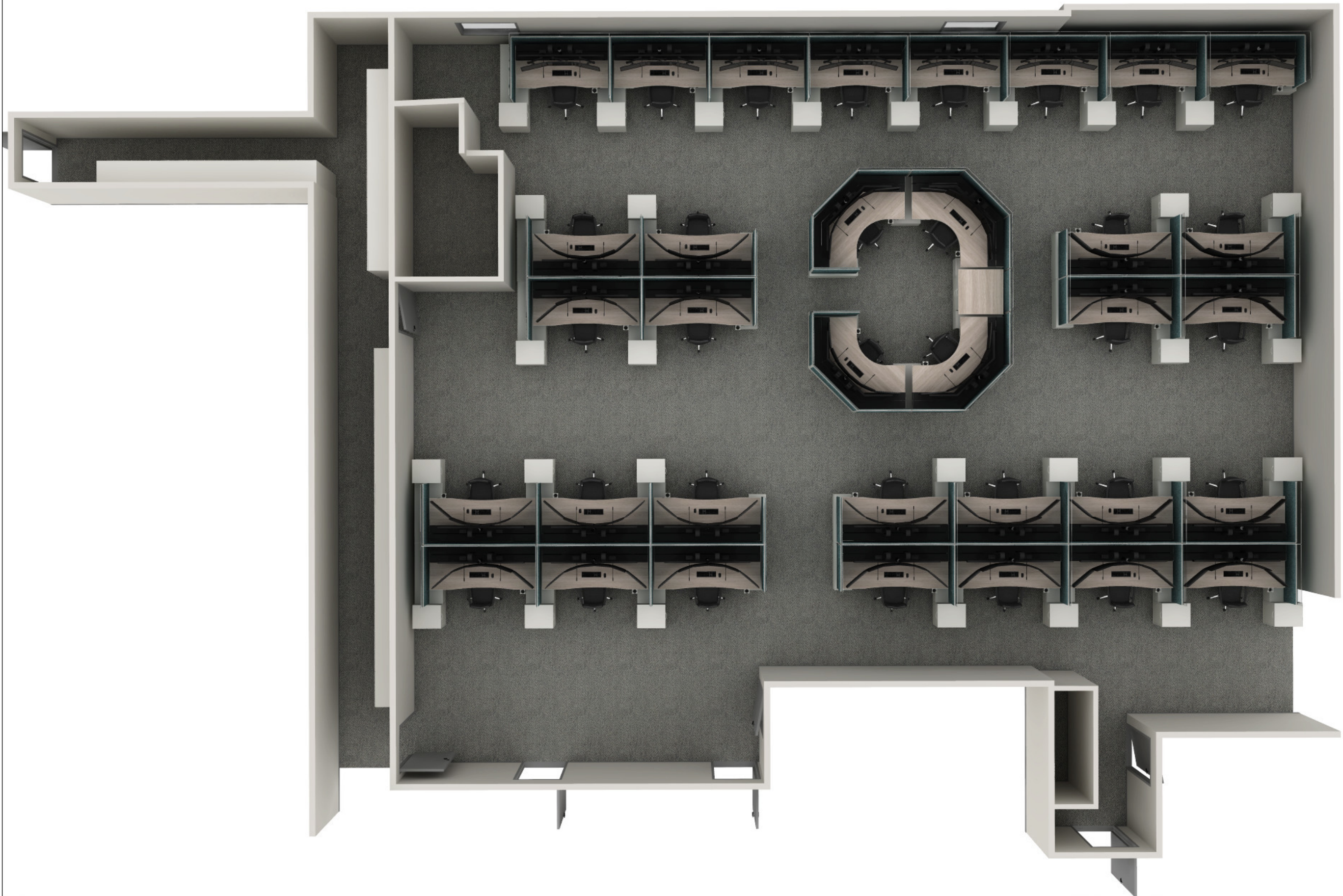

**watson  
consoles**

26246 Twelve Trees Lane NW  
Poulsbo, WA 98370  
www.watsonconsoles.com 360.394.1300  
2022 Watson Furniture Group, Inc. All Rights Reserved

**Project**

Reno-Washoe County 911

**Proposal 1**

**Quote Revision:** 06  
**Quote Date:** 3/31/2025  
**Drawn By:** KH

**Watson Sales Rep**

Quint Andrae

**Watson Account Manager**

Kelsey Hoskins





Project

Reno-Washoe County 911

Proposal 1

Quote Revision: 06

Quote Date: 3/31/2025

Drawn By: KH

Watson Sales Rep

Quint Andrae

Watson Account Manager

Kelsey Hoskins





Project

Reno-Washoe County 911

Proposal 1

Quote Revision: 06

Quote Date: 3/31/2025

Drawn By: KH

Watson Sales Rep

Quint Andrae

Watson Account Manager

Kelsey Hoskins





watson  
consoles

26246 Twelve Trees Lane NW  
Poulsbo, WA 98370  
www.watsonconsoles.com 360.394.1300  
2022 Watson Furniture Group, Inc. All Rights Reserved

Project

Reno-Washoe County 911

Proposal 1

Quote Revision: 06  
Quote Date: 3/31/2025  
Drawn By: KH

Watson Sales Rep

Quint Andrae

Watson Account Manager

Kelsey Hoskins



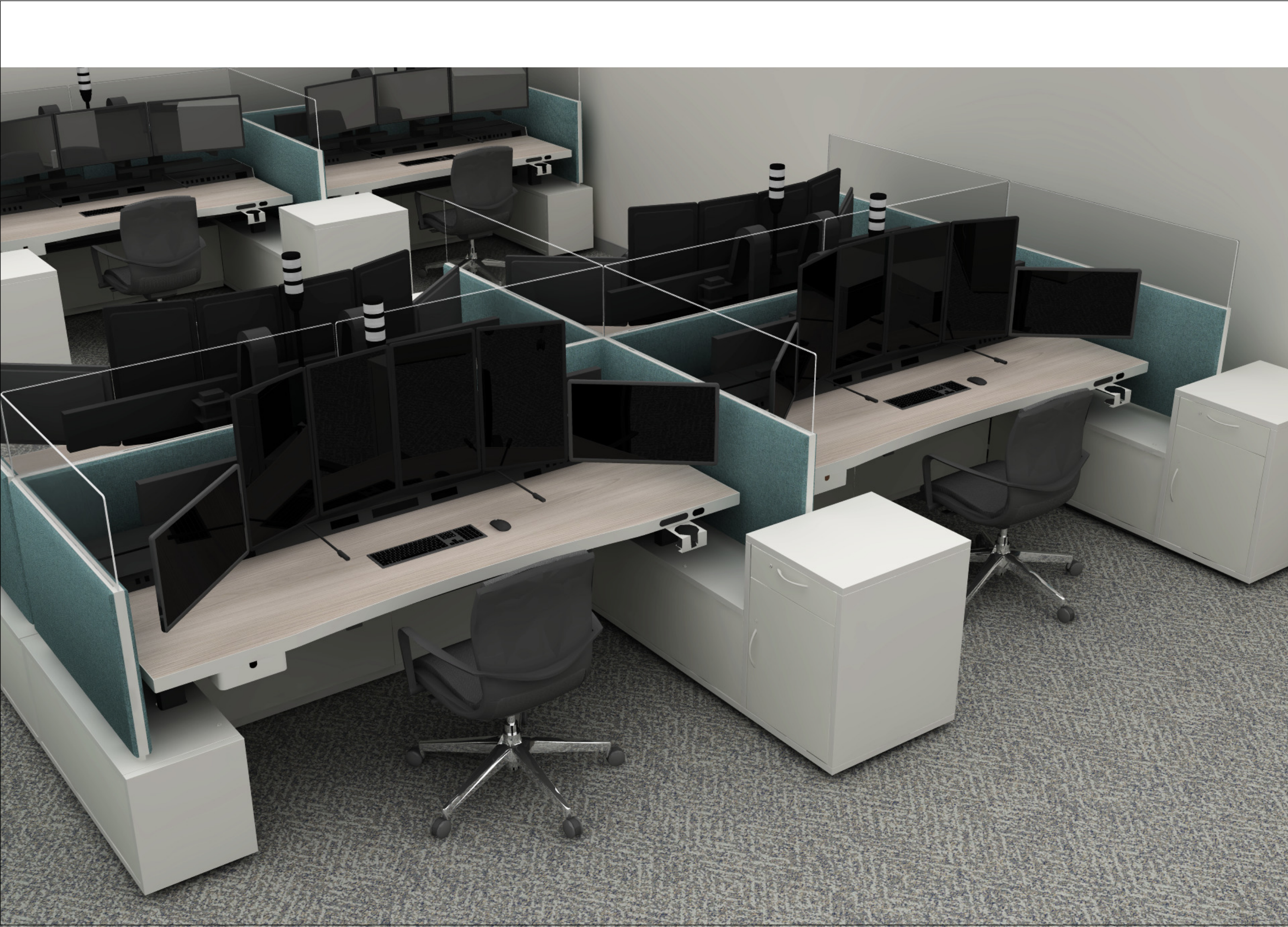

**watson  
consoles**

26246 Twelve Trees Lane NW  
Poulsbo, WA 98370  
www.watsonconsoles.com 360.394.1300  
2022 Watson Furniture Group, Inc. All Rights Reserved

**Project**

Reno-Washoe County 911

**Proposal 1**

**Quote Revision:** 06

**Quote Date:** 3/31/2025

**Drawn By:** KH

**Watson Sales Rep**

Quint Andrae

**Watson Account Manager**

Kelsey Hoskins



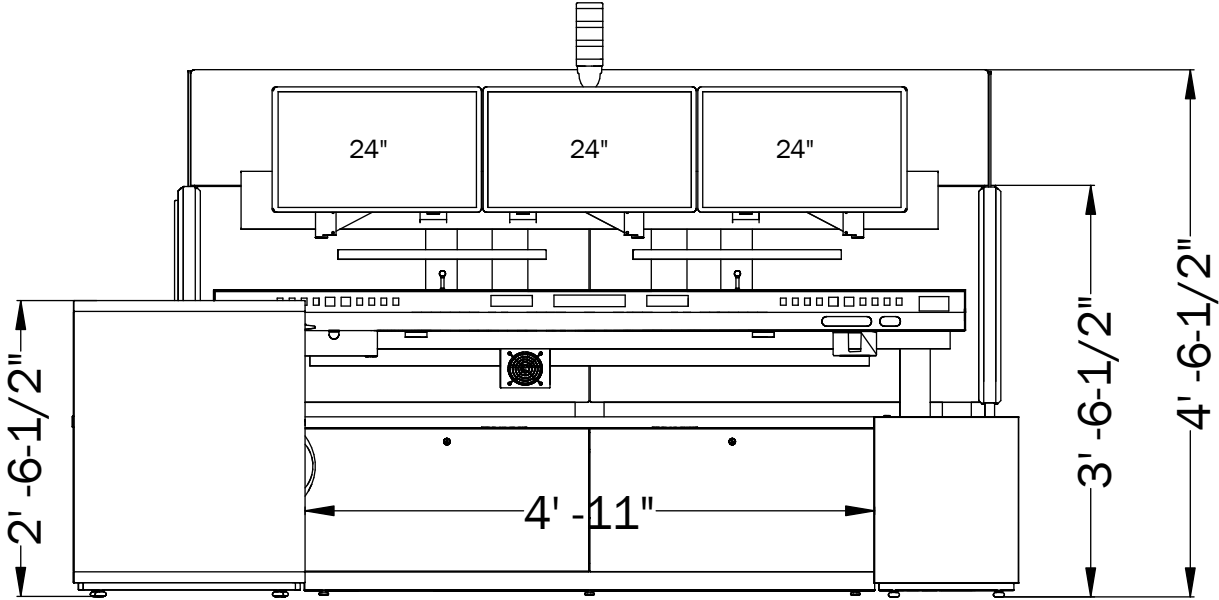
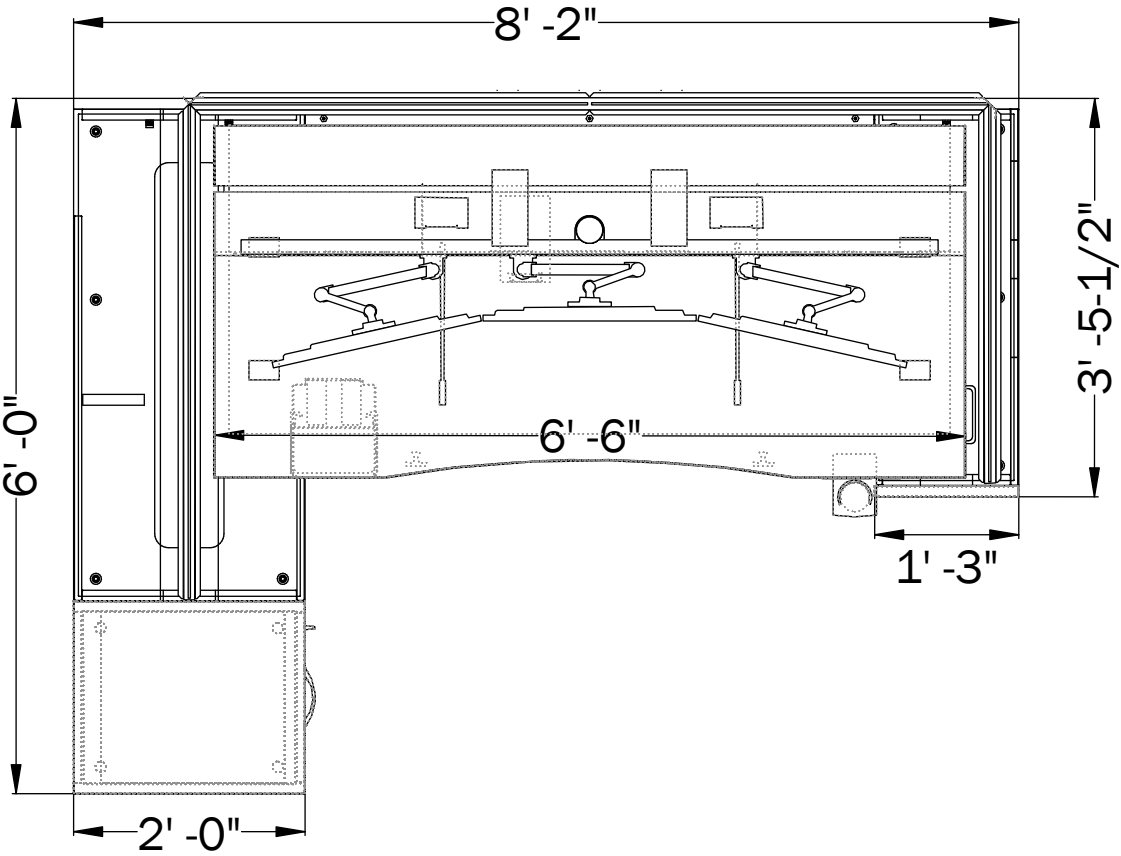

78"W Pro Worksurface

Environmental Control

Status Light

Single Tier Monitor Array

54"H Fabric and Clear Acrylic Screens

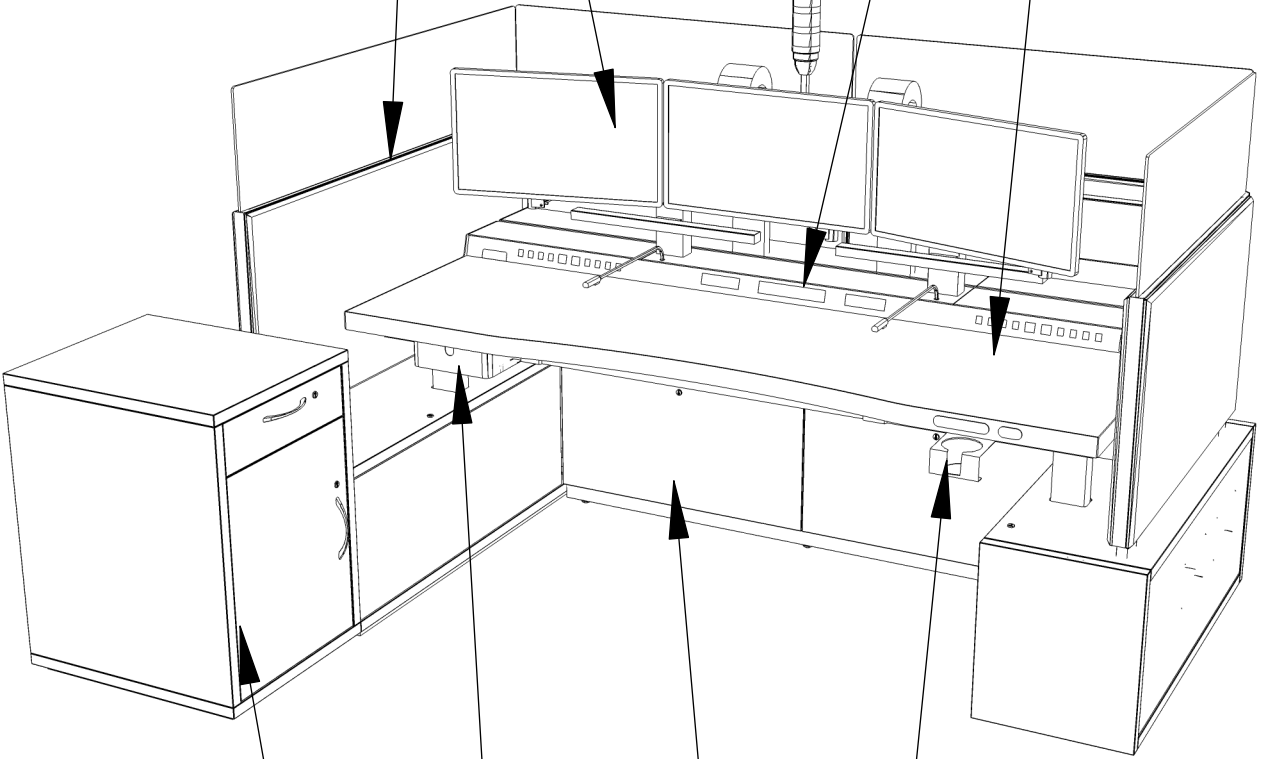

Door / Box

Pendant Drawer

Technology Bridge

Single Cup Holder

**watson  
consoles**

26246 Twelve Trees Lane NW  
Poulsbo, WA 98370  
www.watsonconsoles.com 360.394.1300  
2022 Watson Furniture Group, Inc. All Rights Reserved

**Project**

Reno-Washoe County 911

**Proposal 1**

Quote Revision: 06

Quote Date: 3/31/2025

Drawn By: KH

**Watson Sales Rep**

Quint Andrae

**Watson Account Manager**

Kelsey Hoskins

**Call Taker  
Typical 2D & 3D**



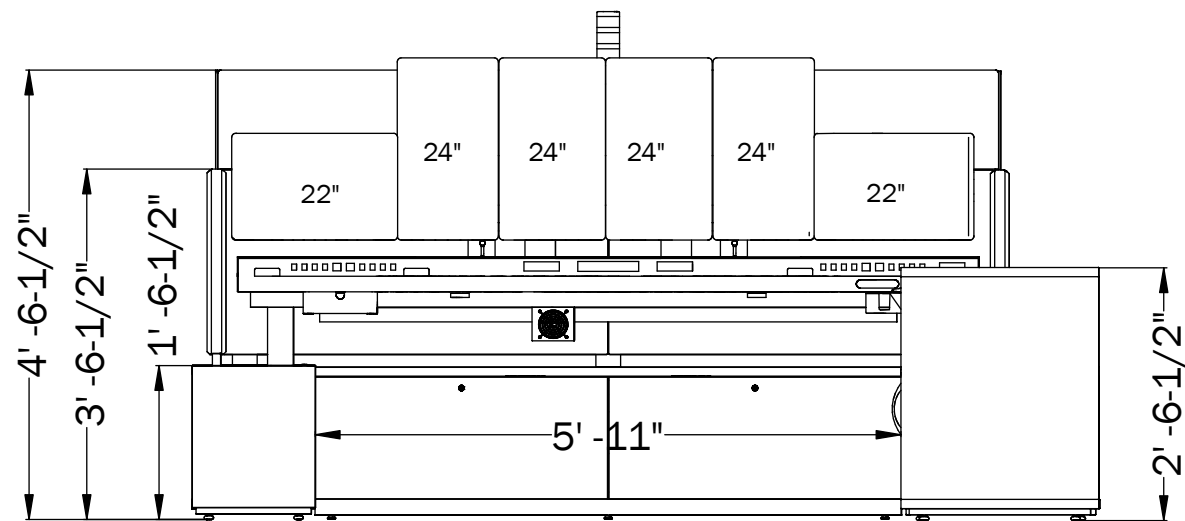
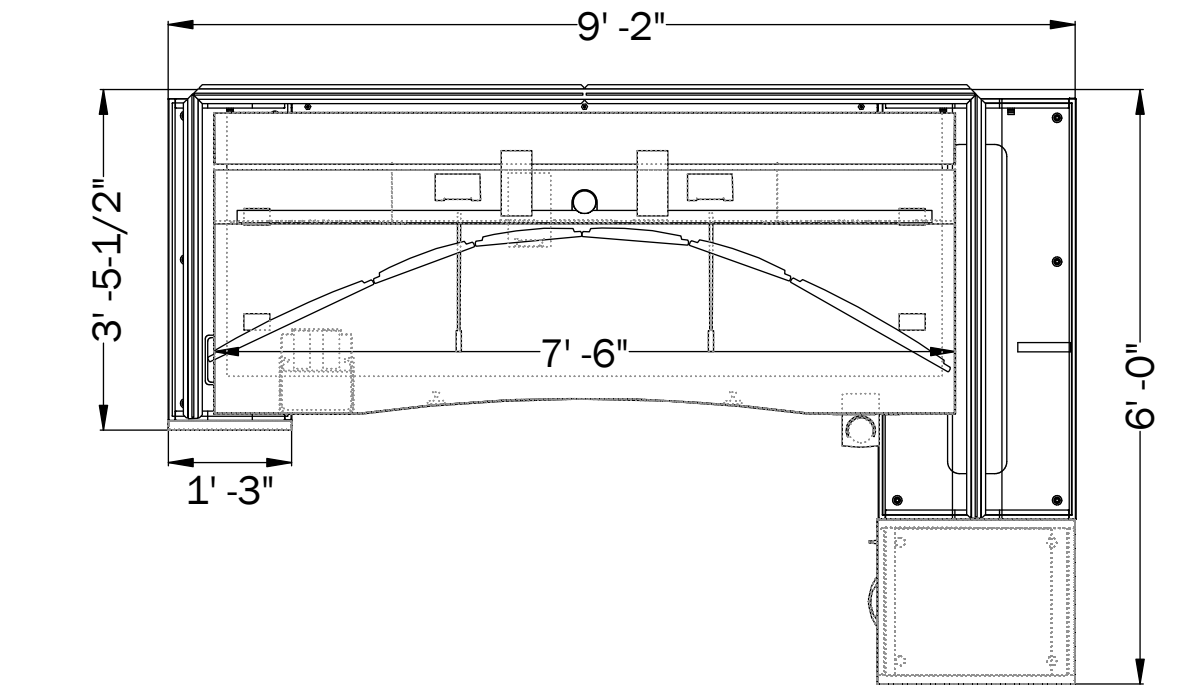

90"W Pro Worksurface

Environmental Control

Status Light

Single Tier Monitor Array

54"H Fabric and Clear Acrylic Screens

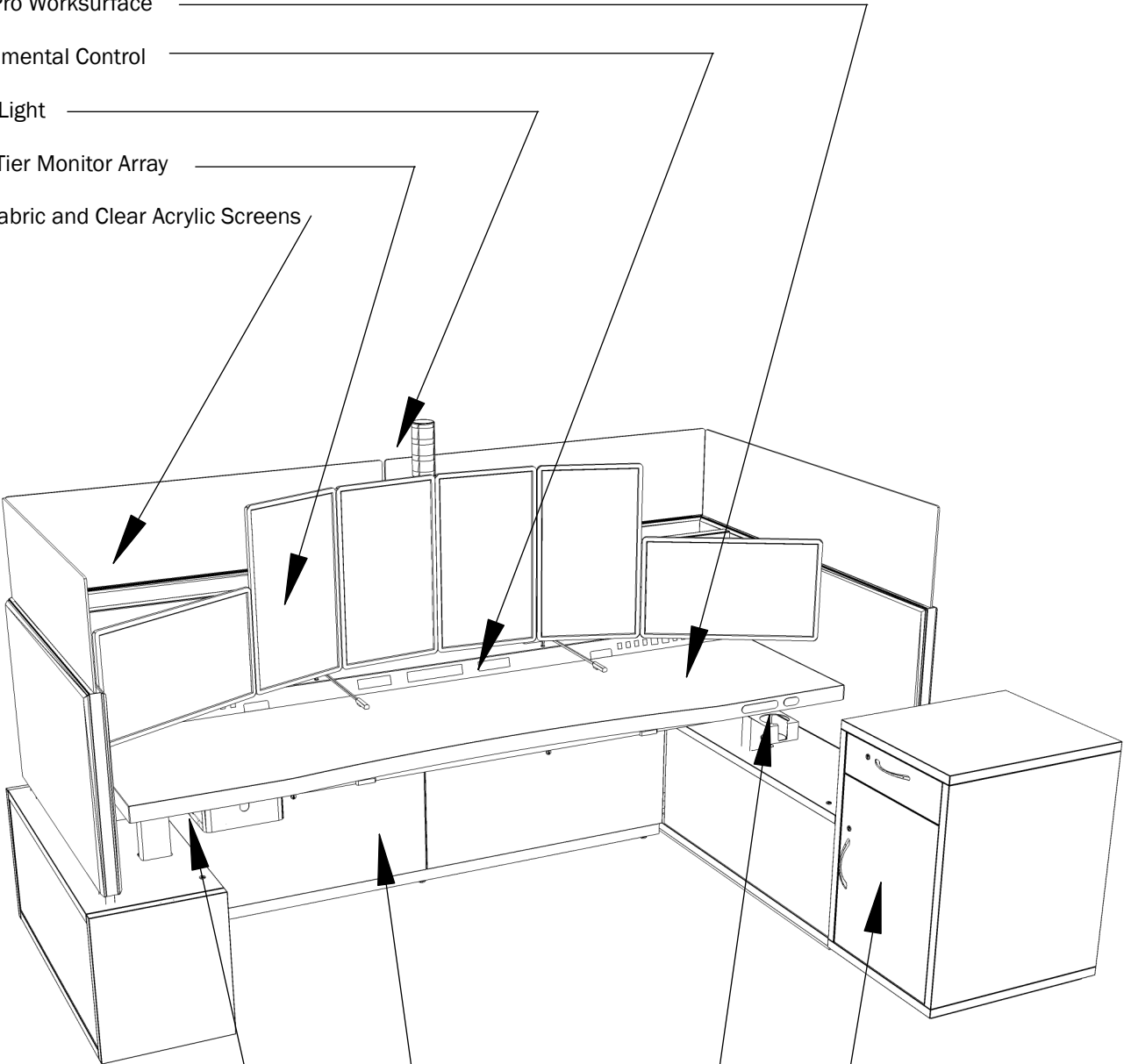

Pendant Drawer

Technology Bridge

Single Cup Holder

Door / Box

**watson  
consoles**

26246 Twelve Trees Lane NW  
Poulsbo, WA 98370  
www.watsonconsoles.com 360.394.1300  
2022 Watson Furniture Group, Inc. All Rights Reserved

**Project**

Reno-Washoe County 911

**Proposal 1**

Quote Revision: 06

Quote Date: 3/31/2025

Drawn By: KH

**Watson Sales Rep**

Quint Andrae

**Watson Account Manager**

Kelsey Hoskins

**Dispatcher  
Typical 2D & 3D**

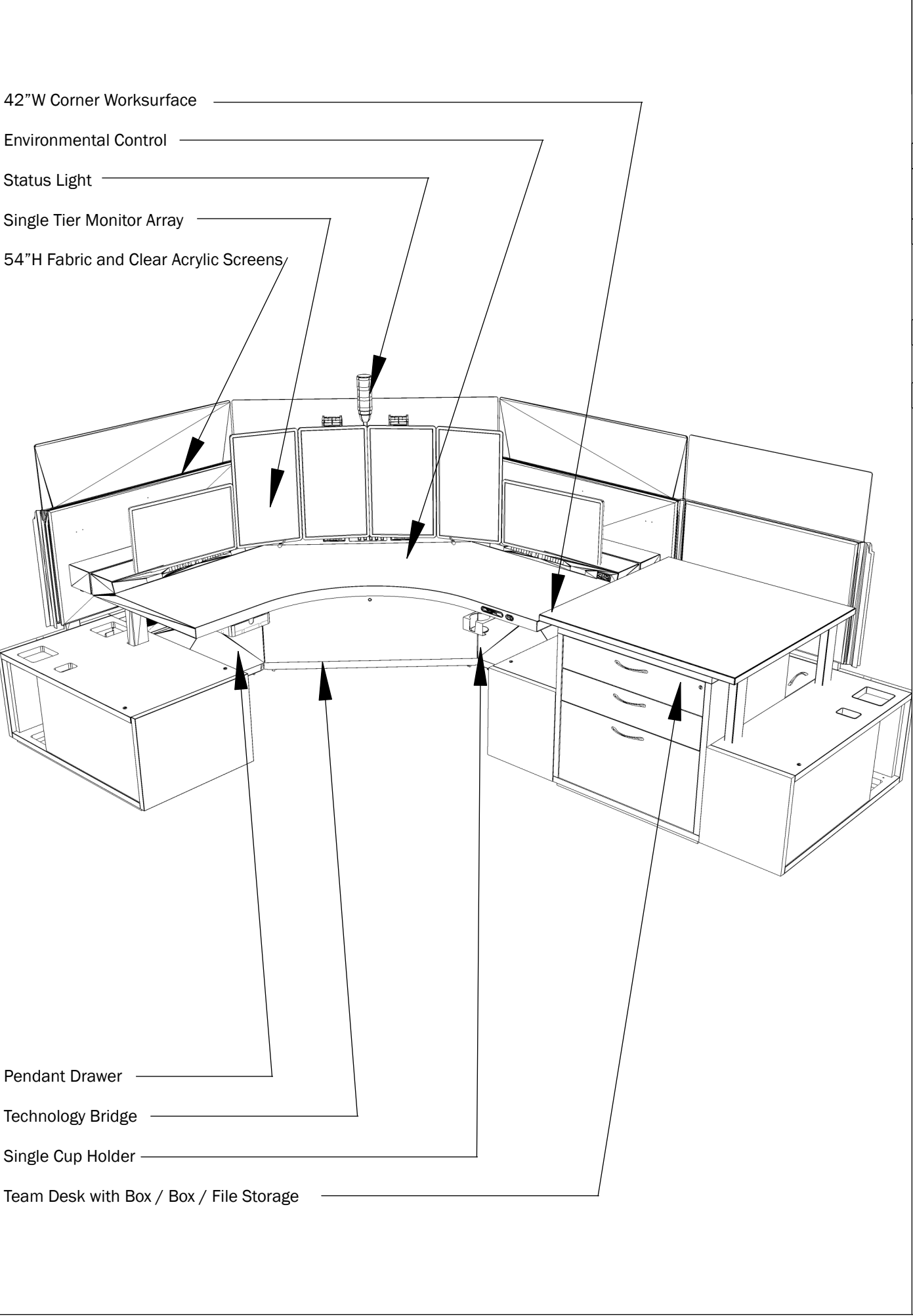
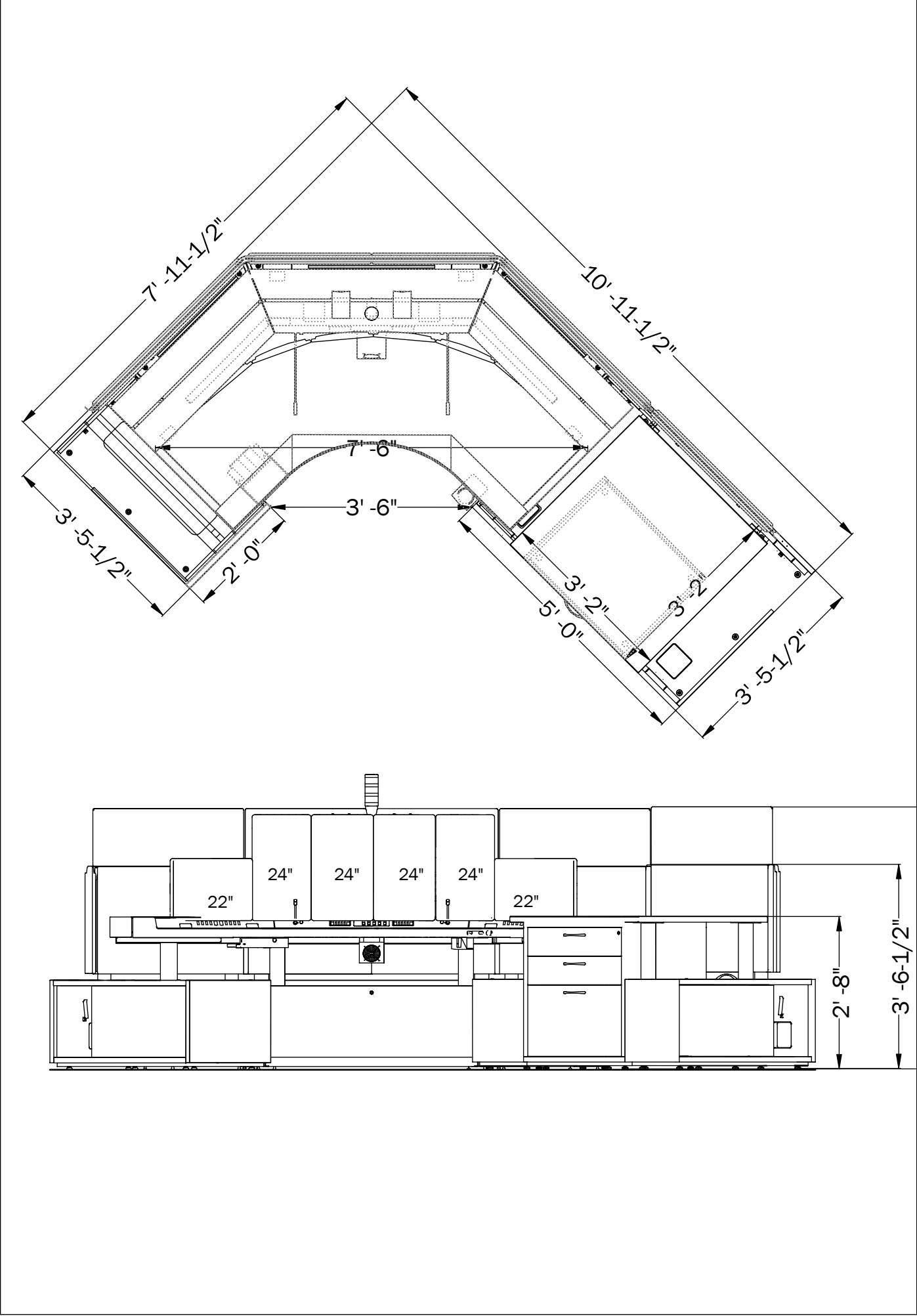

**watson**  
consoles

26246 Twelve Trees Lane NW

Poulsbo, WA 98370

www.watsonconsoles.com 360.394.1300

2022 Watson Furniture Group, Inc. All Rights Reserved

<b>Project</b>
Reno-Washoe County 911
<b>Proposal 1</b>
Quote Revision: 06
Quote Date: 3/31/2025
Drawn By: KH
<b>Watson Sales Rep</b>
Quint Andrae
<b>Watson Account Manager</b>
Kelsey Hoskins

**Supervisor**  
Typical 2D & 3D

Mercury Pro All Call Takers and Dispatch Positions

Project

Reno-Washoe County 911

Proposal 1

Quote Revision: 06  
Quote Date: 3/31/2025  
Drawn By: KH

Watson Sales Rep

Quint Andrae

Watson Account Manager

Kelsey Hoskins

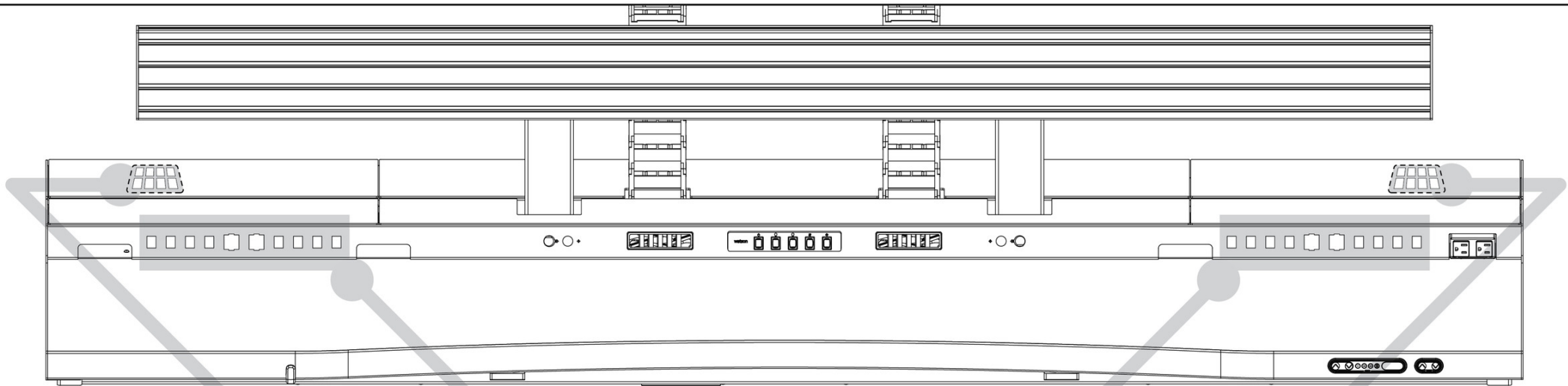

Left Rear Ports

Monitor data ports, speakers  
and/or video touchscreens.

Right Rear Ports

Monitor data ports, speakers  
and/or video touchscreens.

Left User Data Ports

USB power available in large ports only.

Right User Data Ports

USB power available in large ports only.

Data Port Types

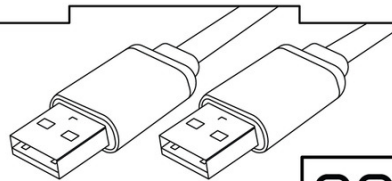
 **USB-A + USB-A Power**  
Specified in large center ports only

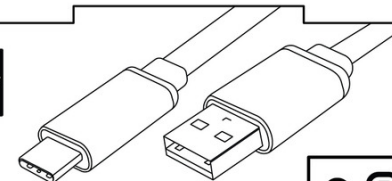
 **USB-C + USB-A Power**  
Specified in large center ports only

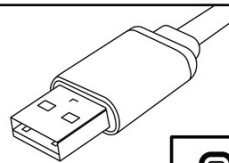
 **USB-A**

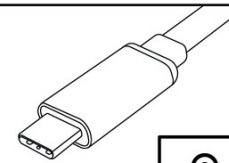
 **USB-C**

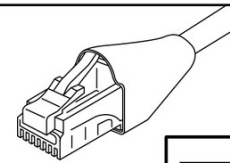
 **CAT6/RJ45**

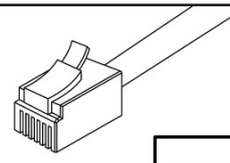
 **RJ12**

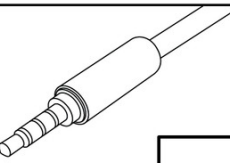
 **3.5 Stereo**

Mercury Corner Supervisors

Project

Reno-Washoe County 911

Proposal 1

Quote Revision: 06  
Quote Date: 3/31/2025  
Drawn By: KH

Watson Sales Rep

Quint Andrae

Watson Account Manager

Kelsey Hoskins

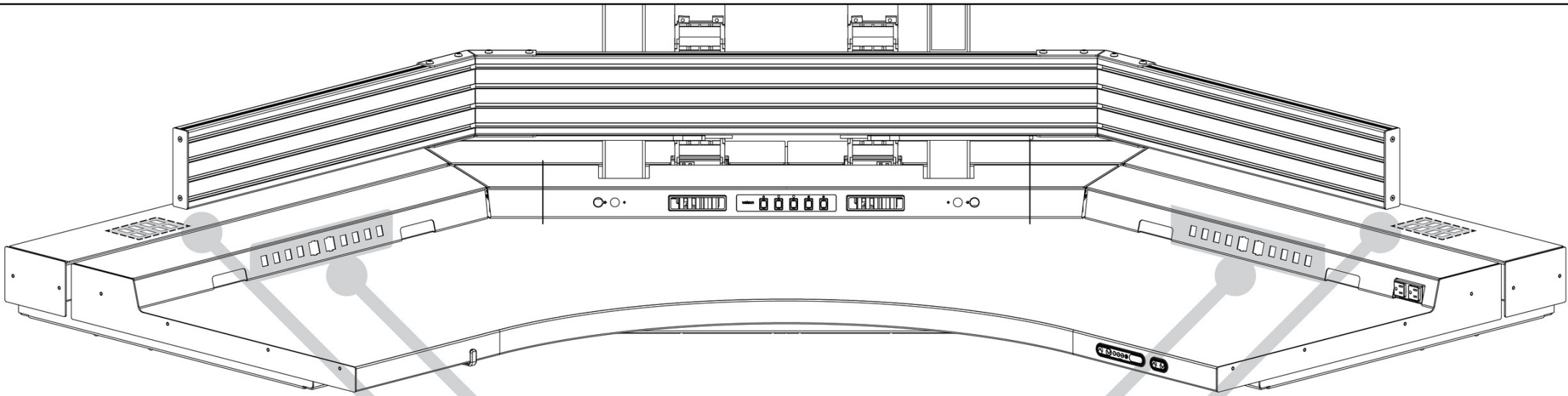

Left Rear Ports

Monitor data ports, speakers  
and/or video touchscreens.

Right Rear Ports

Monitor data ports, speakers  
and/or video touchscreens.

Left User Data Ports

USB power available in large ports only.

Right User Data Ports

USB power available in large ports only.

Data Port Types

USB-A + USB-A Power  
Specified in large center ports only

USB-C + USB-A Power  
Specified in large center ports only

USB-A

USB-C

CAT6/RJ45

RJ12

3.5 Stereo



Proposal 1 - Quote

Project: Reno-Washoe County 911

**Sold to**  
Company name: Reno/Washoe County 911  
Contact Person: Cody Shadle  
Contact Phone: 7753342212  
Contact Fax:

**Distributor**  
Company name: Watson Consoles West  
Salesperson: Quint Andrae  
Salesperson Phone: 3603941300  
Salesperson Fax: 2533481887



#	Qty	Part Number	Description	Sell	Ext. Sell
Call Takers					
1	1	HD6H153918R-G	MERCURY PRO HUB, 15"D x 39"W x 18"H, RIGHT HAND, WITH GROMMET	\$1,830.28	\$1,830.28
2	7	HD6H245118C	MERCURY PRO HUB, 24"D x 51"W x 18"H, CENTER	\$3,423.33	\$23,963.31
3	1	HD6H245118L-N	MERCURY PRO HUB, 24"D x 51"W x 18"H, LEFT HAND, NO GROMMET	\$2,110.44	\$2,110.44
4	8	HD6W3678S	MERCURY PRO WORKSURFACE WITH DEPTH ADJUSTMENT, 36"D x 78"W x 24-50"H, WITH CONTOUR EDGE, SINGLE TIER ARRAY	\$4,965.26	\$39,722.08
5	8	HG6TS78G	MERCURY TECH BRIDGE, SINGLE SIDED 12" D X 18"H, FOR A 78"W CONSOLE, WITH GROMMET	\$640.09	\$5,120.68
6	8	HGA	MERCURY ARRAY	\$1,165.65	\$9,325.20
7	1	HGBS1518D-R	MERCURY BRIDGE SPACER, 15"D x 18"H DUAL, RIGHT HAND	\$53.17	\$53.17
8	7	HGBS2418D-C	MERCURY BRIDGE SPACER, 24"D x 18"H DUAL, CENTER	\$73.62	\$515.34
9	1	HGBS2418D-L	MERCURY BRIDGE SPACER, 24"D x 18"H DUAL, LEFT HAND	\$73.62	\$73.62
10	8	HGPBDB242030L	MERCURY PERSONAL BASE, DOOR BOX, 24"D x 20"W x 30"H, LEFT HAND	\$646.22	\$5,169.76
11	1	HGSOCBKT42L	MERCURY OUTSIDE CORNER BRACKET, 42"H	\$28.63	\$28.63
12	1	HGSOCBKT42R	MERCURY OUTSIDE CORNER BRACKET, 42"H	\$28.63	\$28.63
13	1	HGSR3954FAC	MERCURY RETURN SCREEN, 39"W x 54"H, FABRIC AND 12" CLEAR ACRYLIC	\$695.30	\$695.30
14	8	HGSR5154FAC	MERCURY RETURN SCREEN, 51"W x 54"H, FABRIC AND 12" CLEAR ACRYLIC	\$736.20	\$5,889.60
15	8	HGSS7854FAC	MERCURY SPINE SCREEN, 78"W x 54"H, FABRIC AND 12" CLEAR ACRYLIC	\$1,169.74	\$9,357.92
16	7	HGSWIBKT42	MERCURY WINGED BRACKET, 42"H	\$24.54	\$171.78
17	1	HHC1518	MERCURY HUB COVER, 15"D x 18"H	\$36.81	\$36.81
18	8	TXX4LM-KIT	2 – 4 LIGHT MANUAL SWITCH AND KIT - *NO POWER SUPPLY*	\$49.08	\$392.64
19	8	TXXHGCHS	MERCURY SINGLE CUP HOLDER, 6.7"D X 4.5"W X 2.5"H	\$20.45	\$163.60
20	8	TXXHGDWR	MERCURY PENDANT DRAWER, FOR USE ON MERCURY PRO WORKSURFACES, 5.625"D X 12"W X 2.625"H	\$171.78	\$1,374.24
21	8	TXXSTATUS-3LPS	STATUS LIGHT R/Y/G WITH POWER SUPPLY	\$797.55	\$6,380.40
22	8	TXXTECHAUDIO25	TECH LINK, 3.5MM STEREO AUDIO JACK, BLACK, 25' CORD	\$24.54	\$196.32
23	8	TXXTECHDATA25	TECH LINK, CAT6 / RJ45, DATA, BLACK, 25' CORD	\$44.99	\$359.92
24	8	TXXTECHPH25	TECH LINK, RJ11 / RJ12 PHONE JACK, BLACK, 25' CORD	\$20.45	\$163.60
25	32	TXXTECHUSB15	TECH LINK, SINGLE USB A, DATA, BLACK, 15' CORD	\$28.63	\$916.16
26	16	TXXTECHUSBP-ACB	TECH LINK, USB A+C, CHARGER, BLACK	\$110.43	\$1,766.88
27	8	TXXULALS5178W	HG WHITE UPLIT ACRYLIC LINEAR, 51 RET X 78 SPN	\$507.16	\$4,057.28
28	1	TXXULARS39W	HG WHITE UPLIT ACRYLIC RETURN, 39 RET	\$130.88	\$130.88
29	32	TXXUSBC-DATA	TECH LINK, SINGLE USB C, DATA, BLACK, 15' CORD	\$53.17	\$1,701.44
Total Call Takers					\$121,695.91
Dispatchers					
30	4	HD6H153918L-N	MERCURY PRO HUB, 15"D x 39"W x 18"H, LEFT HAND, NO GROMMET	\$1,807.78	\$7,231.12
31	4	HD6H153918R-N	MERCURY PRO HUB, 15"D x 39"W x 18"H, RIGHT HAND, NO GROMMET	\$1,807.78	\$7,231.12
32	14	HD6H245118C	MERCURY PRO HUB, 24"D x 51"W x 18"H, CENTER	\$3,423.33	\$47,926.62
33	3	HD6H245118L-G	MERCURY PRO HUB, 24"D x 51"W x 18"H, LEFT HAND, WITH GROMMET	\$2,132.94	\$6,398.81

Proposal 1 - Quote

Project: Reno-Washoe County 911

**Sold to**  
Company name: Reno/Washoe County 911  
Contact Person: Cody Shadle  
Contact Phone: 7753342212  
Contact Fax:

**Distributor**  
Company name: Watson Consoles West  
Salesperson: Quint Andrae  
Salesperson Phone: 3603941300  
Salesperson Fax: 2533481887



#	Qty	Part Number	Description	Sell	Ext. Sell
34	1	HD6H245118L-N	MERCURY PRO HUB, 24"D x 51"W x 18"H, LEFT HAND, NO GROMMET	\$2,110.44	\$2,110.44
35	4	HD6H245118R-G	MERCURY PRO HUB, 24"D x 51"W x 18"H, RIGHT HAND, WITH GROMMET	\$2,132.94	\$8,531.74
36	22	HD6W3690S	MERCURY PRO WORKSURFACE WITH DEPTH ADJUSTMENT, 36"D x 90"W x 24-50"H, WITH CONTOUR EDGE, SINGLE TIER ARRAY	\$5,042.97	\$110,945.34
37	11	HG6TD90	MERCURY TECH BRIDGE, DOUBLE SIDED 23" D X 18"H, FOR A 90"W CONSOLE	\$1,194.28	\$13,137.08
38	22	HGA	MERCURY ARRAY	\$2,049.09	\$45,079.98
39	4	HGBS1518D-L	MERCURY BRIDGE SPACER, 15"D x 18"H DUAL, LEFT HAND	\$53.17	\$212.68
40	7	HGBS2418D-C	MERCURY BRIDGE SPACER, 24"D x 18"H DUAL, CENTER	\$73.62	\$515.34
41	4	HGBS2418D-R	MERCURY BRIDGE SPACER, 24"D x 18"H DUAL, RIGHT HAND	\$73.62	\$294.48
42	11	HGPBDB242030L	MERCURY PERSONAL BASE, DOOR BOX, 24"D x 20"W x 30"H, LEFT HAND	\$646.22	\$7,108.42
43	11	HGPBDB242030R	MERCURY PERSONAL BASE, DOOR BOX, 24"D x 20"W x 30"H, RIGHT HAND	\$646.22	\$7,108.42
44	8	HGSR3954FAC	MERCURY RETURN SCREEN, 39"W x 54"H, FABRIC AND 12" CLEAR ACRYLIC	\$695.30	\$5,562.40
45	22	HGSR5154FAC	MERCURY RETURN SCREEN, 51"W x 54"H, FABRIC AND 12" CLEAR ACRYLIC	\$736.20	\$16,196.40
46	11	HGSS9054FAC	MERCURY SPINE SCREEN, 90"W x 54"H, FABRIC AND 12" CLEAR ACRYLIC	\$1,214.73	\$13,362.03
47	8	HGSWIBKT42	MERCURY WINGED BRACKET, 42"H	\$24.54	\$196.32
48	8	HHC1518	MERCURY HUB COVER, 15"D x 18"H	\$36.81	\$294.48
49	22	TXX4LM-KIT	2 – 4 LIGHT MANUAL SWITCH AND KIT - *NO POWER SUPPLY*	\$49.08	\$1,079.76
50	22	TXXHGCHS	MERCURY SINGLE CUP HOLDER, 6.7"D X 4.5"W X 2.5"H	\$20.45	\$449.90
51	22	TXXHGDWR	MERCURY PENDANT DRAWER, FOR USE ON MERCURY PRO WORKSURFACES, 5.625"D X 12"W X 2.625"H	\$171.78	\$3,779.16
52	22	TXXSTATUS-3LPS	STATUS LIGHT R/Y/G WITH POWER SUPPLY	\$797.55	\$17,546.10
53	22	TXXTECHAUDIO25	TECH LINK, 3.5MM STEREO AUDIO JACK, BLACK, 25' CORD	\$24.54	\$539.88
54	22	TXXTECHDATA25	TECH LINK, CAT6 / RJ45, DATA, BLACK, 25' CORD	\$44.99	\$989.78
55	22	TXXTECHPH25	TECH LINK, RJ11 / RJ12 PHONE JACK, BLACK, 25' CORD	\$20.45	\$449.90
56	88	TXXTECHUSB15	TECH LINK, SINGLE USB A, DATA, BLACK, 15' CORD	\$28.63	\$2,519.44
57	44	TXXTECHUSBP-ACB	TECH LINK, USB A+C, CHARGER, BLACK	\$110.43	\$4,858.92
58	11	TXXULALS5190W	HG WHITE UPLIT ACRYLIC LINEAR, 51 RET X 90 SPN	\$527.61	\$5,803.71
59	8	TXXULARS39W	HG WHITE UPLIT ACRYLIC RETURN, 39 RET	\$130.88	\$1,047.04
60	13	TXXULARS51W	HG WHITE UPLIT ACRYLIC RETURN, 51 RET	\$151.33	\$1,967.29
61	88	TXXUSBC-DATA	TECH LINK, SINGLE USB C, DATA, BLACK, 15' CORD	\$53.17	\$4,678.96
Total Dispatchers					\$345,153.06
Supervisors					
62	1	HD6AH153918L-N	MERCURY CORNER/COMMAND HUB, 15"D X 39"W 18"H, LEFT HAND, NO GROMMET	\$916.16	\$916.16
63	1	HD6AH153918R-N	MERCURY CORNER/COMMAND HUB, 15"D X 39"W 18"H, RIGHT HAND, NO GROMMET	\$916.16	\$916.16
64	2	HD6AH243918C	MERCURY CORNER/COMMAND HUB, 24"D X 39"W 18"H, CENTER	\$1,509.21	\$3,018.42
65	4	HD6AT90S42-N	MERCURY CORNER SINGLE TECH BRIDGE, FOR A 90DEG X 42"W CONSOLE, NO GROMMET	\$1,664.63	\$6,658.52
66	4	HD6AW9042S	MERCURY CORNER WORKSURFACE 90 DEG x 42"W, 24-50"H, SINGLE TIER ARRAY	\$5,386.53	\$21,546.12
67	4	HGAC9042	MERCURY CORNER ARRAY 90 DEG x 42"W	\$2,143.16	\$8,572.64

Proposal 1 - Quote

Project: Reno-Washoe County 911

**Sold to**  
Company name: Reno/Washoe County 911  
Contact Person: Cody Shadle  
Contact Phone: 7753342212  
Contact Fax:

**Distributor**  
Company name: Watson Consoles West  
Salesperson: Quint Andrae  
Salesperson Phone: 3603941300  
Salesperson Fax: 2533481887



#	Qty	Part Number	Description	Sell	Ext. Sell
68	4	HGAS90S5442FAC	MERCURY CORNER SINGLE SPINE SCREEN, 90 DEG 54"H X 42"W, FABRIC AND 12" CLEAR ACRYLIC	\$1,431.50	\$5,726.00
69	1	HGBS1518S-L	MERCURY BRIDGE SPACER, 15"D x 18"H SINGLE, LEFT HAND	\$53.17	\$53.17
70	1	HGBS1518S-R	MERCURY BRIDGE SPACER, 15"D x 18"H SINGLE, RIGHT HAND	\$53.17	\$53.17
71	2	HGBS2418S-C	MERCURY BRIDGE SPACER, 24"D x 18"H SINGLE, CENTER	\$73.62	\$147.24
72	1	HGSOCBKT42L	MERCURY OUTSIDE CORNER BRACKET, 42"H	\$28.63	\$28.63
73	1	HGSOCBKT42R	MERCURY OUTSIDE CORNER BRACKET, 42"H	\$28.63	\$28.63
74	2	HGSR3954FAC	MERCURY RETURN SCREEN, 39"W x 54"H, FABRIC AND 12" CLEAR ACRYLIC	\$695.30	\$1,390.60
75	4	HGSWIBKT42	MERCURY WINGED BRACKET, 42"H	\$24.54	\$98.16
76	1	HGTD2SCR3054FAC	MERCURY TEAM DESK SPINE SCREEN, FABRIC AND CLEAR ACRYLIC , 30"W X 54"H, FOR A TEAM DESK, CENTER	\$527.61	\$527.61
77	1	HGTD2SRF3930	MERCURY TEAM DESK SURFACE, RECTANGLE TOP FOR A TEAM DESK, 39"D x 30"W x 31.5"H, LEFT, CENTER, OR RIGHT	\$319.02	\$319.02
78	1	HGTD2STRF30	MERCURY TEAM DESK STORAGE BASE BBL FILE, FOR A 30W TEAM DESK	\$760.74	\$760.74
79	1	HGTDBRDGSS30-C	MERCURY TEAM DESK SINGLE STORAGE BRIDGE, FOR A 30W TEAM DESK, CENTER	\$233.13	\$233.13
80	1	HGTDLHUBA	MERCURY TEAM DESK LEFT HUB CORNER/COMMAND, FOR A TEAM DESK	\$1,096.12	\$1,096.12
81	1	HGTDRHUBA	MERCURY TEAM DESK RIGHT HUB CORNER/COMMAND, FOR A TEAM DESK	\$1,096.12	\$1,096.12
82	2	HHC1518	MERCURY HUB COVER, 15"D x 18"H	\$36.81	\$73.62
83	2	HHC2418	MERCURY HUB COVER, 24"D x 18"H	\$44.99	\$89.98
84	4	TXX4LM-KIT	2 – 4 LIGHT MANUAL SWITCH AND KIT - *NO POWER SUPPLY*	\$49.08	\$196.32
85	4	TXXHADWR	MERCURY PENDANT DRAWER, FOR USE ON MERCURY BASE, STANDARD, AND CORNER/COMMAND WORKSURFACES, 5.625"D X 12"W X 2"H	\$171.78	\$687.12
86	4	TXXHGCHS	MERCURY SINGLE CUP HOLDER, 6.7"D X 4.5"W X 2.5"H	\$20.45	\$81.80
87	4	TXXSTATUS-3LPS	STATUS LIGHT R/Y/G WITH POWER SUPPLY	\$797.55	\$3,190.20
88	4	TXXTECHAUDIO25	TECH LINK, 3.5MM STEREO AUDIO JACK, BLACK, 25' CORD	\$24.54	\$98.16
89	4	TXXTECHDATA25	TECH LINK, CAT6 / RJ45, DATA, BLACK, 25' CORD	\$44.99	\$179.96
90	4	TXXTECHPH25	TECH LINK, RJ11 / RJ12 PHONE JACK, BLACK, 25' CORD	\$20.45	\$81.80
91	16	TXXTECHUSB15	TECH LINK, SINGLE USB A, DATA, BLACK, 15' CORD	\$28.63	\$458.08
92	8	TXXTECHUSBP-ACB	TECH LINK, USB A+C, CHARGER, BLACK	\$110.43	\$883.44
93	4	TXXULACRS42W	HG WHITE UPLIT ACRYLIC CORNER, 42W, SINGLE	\$633.95	\$2,535.80
94	2	TXXULARS39W	HG WHITE UPLIT ACRYLIC RETURN, 39 RET	\$130.88	\$261.76
95	1	TXXULATDC30W	HG WHITE UPLIT ACRYLIC TEAM DESK, 30W, CENTER	\$118.61	\$118.61
96	16	TXXUSBC-DATA	TECH LINK, SINGLE USB C, DATA, BLACK, 15' CORD	\$53.17	\$850.72
97	1	WAKEY-STD	MASTER KEY, STANDARD LOCK (082000)	\$24.54	\$24.54
98	1	WELCOMEPACKET	WATSON CONSOLES WELCOME PACKET	\$0.00	\$0.00

Total Supervisors \$62,998.27

Product Subtotal \$529,847.23  
Watson Installation (Empty Room Pricing) \$129,547.00

# Proposal 1 - Quote

Project: Reno-Washoe County 911

**Sold to**

Company name: Reno/Washoe County 911  
Contact Person: Cody Shadle  
Contact Phone: 7753342212  
Contact Fax:

**Distributor**

Company name: Watson Consoles West  
Salesperson: Quint Andrae  
Salesperson Phone: 3603941300  
Salesperson Fax: 2533481887



#	Qty	Part Number	Description	Sell	Ext. Sell
				Installation Surcharge for Prevailing Wage Requirements	\$38,864.10
				Freight	\$25,909.40
				<b>Grand Total</b>	<b>\$724,167.73</b>